

OR-T 231-C2F/C4F

Automatic strapping machine Vertical strapping

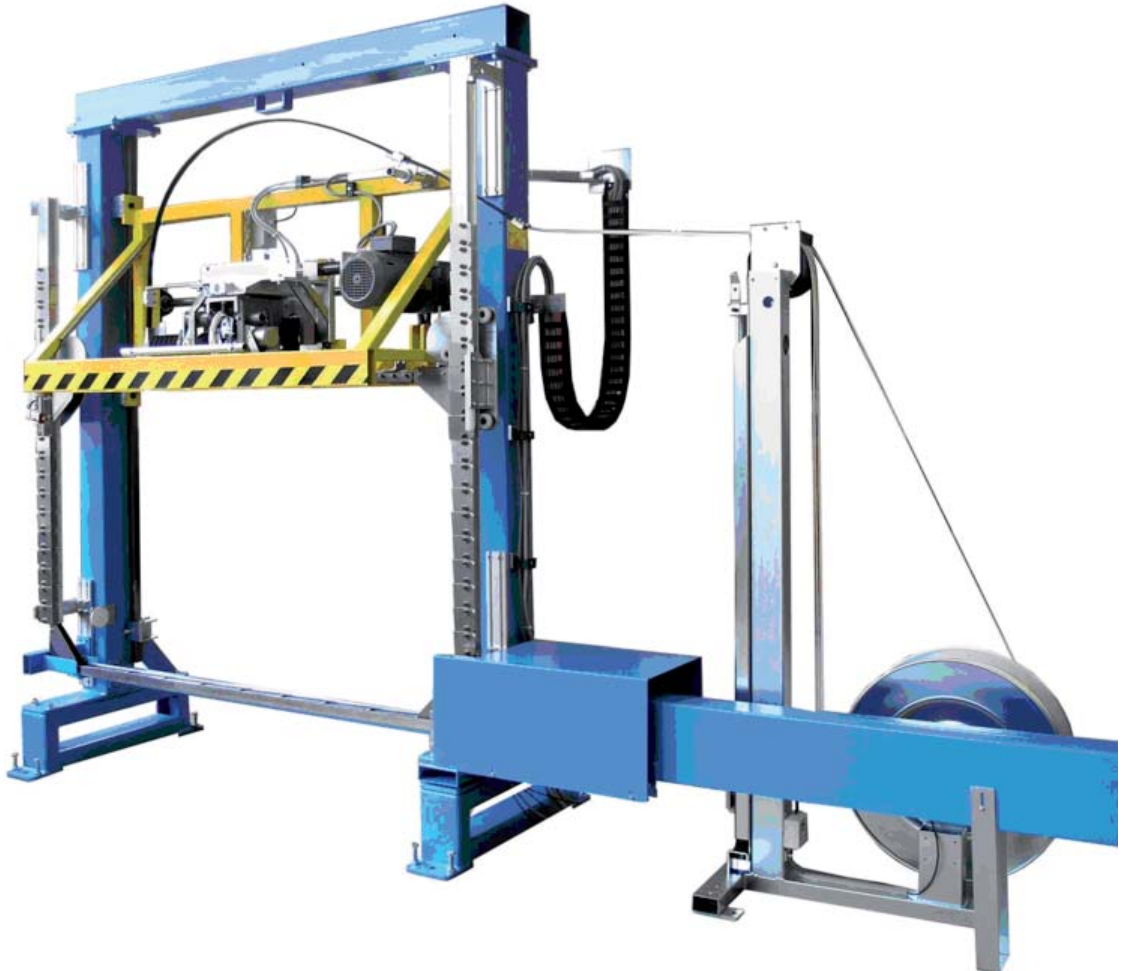

Customer benefits

Characteristics

Segmented track system

Adjustable, electronically controlled strap tension, floating head

User-friendly control panel with push buttons and display

Robust and proven design with first class industrial components

Customer benefits

· Strap infeed at all heights possible

· Maximum product securing during transportation thanks to balanced strap tension around the package

· Easy operation
· Secure continuous duty

· High availability
· Low maintenance cost

Technical data

Machine

Strapping cycle time	Per strap, approx. 10 s (Underfeed) 17 s (Lance)	Arch dimensions	See page 4
Strap tension	200–2200 N (head OR-T 230) 500–5000 N (head OR-T 240) Adjustable by potentiometer, electronically controlled Floating head ensures equalised strap tension around package	Sword or underfeed	Lance: For Euro pallets Underfeed: For packages
Strap tensioning way of the strapping head	200 mm (head OR-T 230) Unlimited (head OR-T 240)	Strap dispenser	Separate strap dispenser with accumulator
Carriage vertical speed	Approx. 160 mm/s	Strap end	Automatic strap end detection
Sealing method	Heat weld sealing system for PP and PET, simple adjustment	Colours	Frame: Blue, RAL 5012 Movable parts: Yellow, RAL 1023 Control desk: Grey, RAL 7035
Conveying height	From 320 mm	Electrical supply	400 VAC, 50 Hz, 3PE Rated power 4 kW
		Compressed air	5–6 bar Consumption 16 NI/cycle
		Machine weight	Approx. 1500 kg

Conveyor

The conveying systems is not part of the OR-T 231-C2F/C4F machine

Control system

Stand alone control desk

- The Man Machine Interface consists of
- Main switch and Emergency push button
 - Push button for various start functions
 - Selector switches for machine mode and program
 - Potentiometer for strap tension selection
 - Indicator lamps for machine on condition indication
 - Numerical display for machine condition indication

Standard strapping programs

- Service
- Manual
- Automatic
- Pass through

PLC Simatic S7-300

Interface, signal exchange

All signals for exchange must be potential free

The strapping machine is able to receive the following signals

- Start of the selected strapping program
- Confirmation: Conveyor not in motion
- External Emergency-Stop is activated
- External safety clear (light barriers, access door etc.)

The strapping machine sends the following signals

- Strapping program completed (automatic mode)
- Conveyor release
- Activated emergency-Stop on the strapping machine

Detailed description "Signal Exchange" available

Strap

Polyester (PET)	Width 12, 16, 19 mm Thickness 0,56–0,8 mm	Core size	Ø 406 mm Width 152 mm
Polypropylene (PP)	Width 12, 16, 19 mm Thickness 0,7–0,85 mm		

Features



Simple operation

User friendly control panel



Numerical display for machine condition indication



Segmented track system

Strap infeed at all heights possible



Maximum product securing during transportation

Adjustable strap tension, electronically controlled, floating head for balanced strap tension around the package



Long life cycle and low maintenance cost

First class industrial components, e.g. SEW motors, powered by frequency controller for fast movement and precise control

Options

Top compression

2000–6000 N, fully adjustable

Strapping head OR-T 240

(instead of OR-T 230)

For high tension applications (500–5000 N)

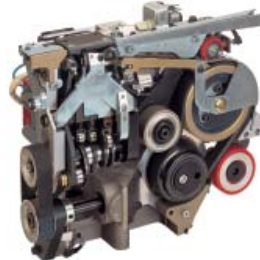

Top edge protector device "SE"

See drawing 1884-300-052 and STX SE 03 02 10
Warning min. corner in magazine (not in combination with top compression)

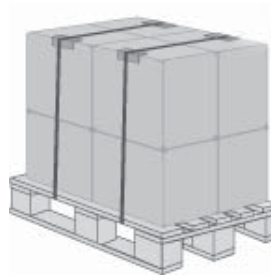

Min. package height 200 mm (incl. pallet)

For machine with sword, instead of min. 450 mm

Max. package height 2350 mm (incl. pallet)

Instead of max. 1850 or 1350 mm

Strap end pre-warning

To ensure short machine downtimes when changing coils



Flash light

General fault signal with red indicator lamp



Control components for one conveyor

Consists of

- Two outputs for one motor (0,7–1,1 kW)
- Three inputs for light barriers

Without software



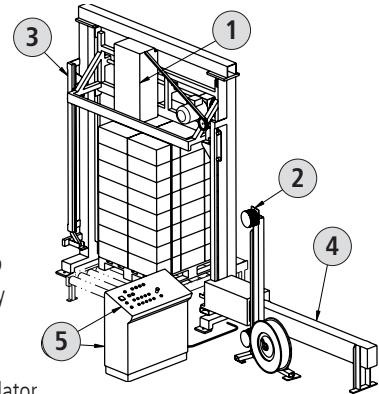
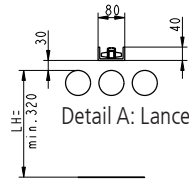
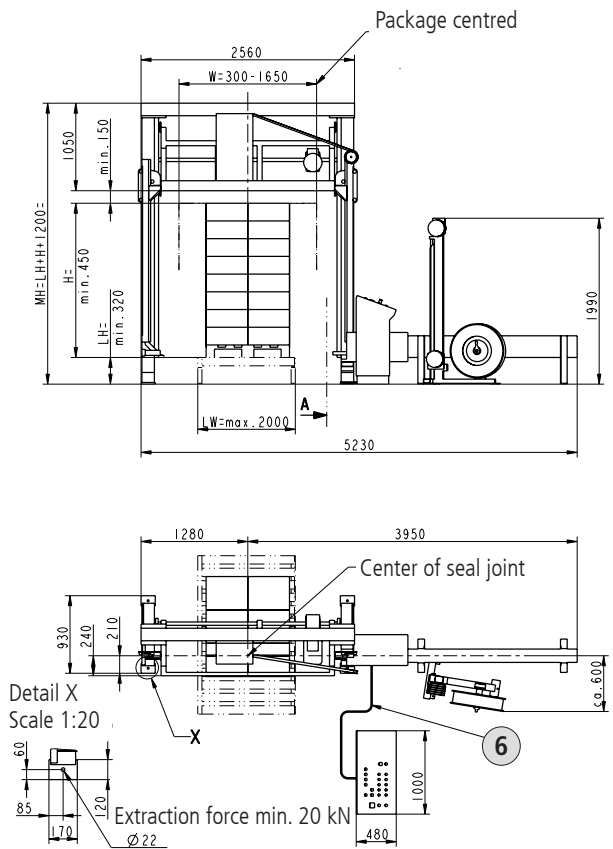

- 1 Strapping head for high strap tension, operational reliability and easy maintenance
- 2 Strap dispenser with accumulator
- 3 Telescope strap guide
- 4 Lance with friction drive, adjustable height ± 15 mm
- 5 Control system with programmable controller
- 6 Cable length standard: 3 m (optional ... m according order)

Arch dimensions OR-T 230-C2F/C4F

Arch width and arch height can be combined

Package width	300-850 (W* = 850)	300-1250 (W* = 1250)	300-1650 (W* = 1650)
Package height			
450-2350 (H = 2350)			
450-1850 (H = 1850)			
450-1350 (H = 1350)			

* Max.

Standard H = Arch height
 Special W = Arch width

ORGAPACK GmbH
Packaging Technology

Silbernstrasse 14
CH-8953 Dietikon
Phone +41 44 745 50 50
Fax +41 44 745 52 16
pt@orgapack.com
www.orgapack.com

Certificate ISO 9001 / EN 29001