

OR-M 550 / 555

High performance machines for plastic strapping



Customer benefits

Characteristics

Up to 70 cycles per minute

Touch Panel

Simple technology, few moving parts

Constant strap tension

Ergonomically positioned dispenser

Customer benefits

- Fast strapping

- Strap tension easily adjustable
- Flush operator controls
- No exposed operator functions

- Reliable, also in continuous operation
- Easily accessible (without tools)

- For small to large packages
- For soft and hard products

- Simple and rapid coil change

Highlights



Lightweight strap for cost effective strapping

Use of thin PP strap or 5 mm PP strap with OR-M 550 as alternative to 9/12 mm strap



Minimum maintenance requirement

without tools



Simple coil change



Easy fault clearance

without tools



Robust, compact design

Fully automatic machines with integrated conveyor, for new or existing production and packaging lines

Exceptionally easy operation

Strap tension adjustable with press button

Standard equipment

- Adjustable conveyor height
- Swinging out belt conveyor system
- Four transport rollers, with two braked
- Closed strap arch system
- Heat seal
- Automatic strap threading device
- Automatic strap end ejection
- Automatic strap loop ejection for cycles without product
- Cycle counter
- Electronic control system with microprocessor + Siemens S7-200 SPS
 - Free memory capacity for peripheral modules
 - Control elements linkable with external control cabinet (by Bus)
- Emergency push button
- Dispenser, side-mounted on machine frame
- Electrical supply cable, 5 m
- Operation / Indication**
 - Touch Panel, mounted on dispenser side
 - Graphic display for program selection and strap interspace
 - Error message display
- Interface**
 - One 24 pole harding connector
 - All output (transmitting) signals potential free
 - Ready signal to feed conveyor
 - General fault signal
 - Input signal, potential free
 - Ready signal from follow-on conveyor
- Basic photocell** for collecting and positioning the packages

Strapping programs

Standard strapping modes



Pass through without strapping



Single strap



Two straps



Three straps



Multiple strapping of long packages with regular strap distances

Technical data

Machines

- Heat weld sealing, preheating time 30 s
- Electrical supply 230 V, 50 Hz, 6,3 AT, 1 NPE
- Power current fuse 10 AT
- Conveyor height 720–950 mm
- Conveyor speed, fully adjustable 5–45 m/min
- Machine weight 240 kg
- Colour Yellow: RAL 1007

Packages

- Min. width 100 mm
- Max. width/height Arch dimension / 50 mm
- Min. length 150 mm
- Max. weight 35 kg

Plastic strap (PP)

Width	5 mm	372.605.585
	9 mm	371.609.555
	12 mm	371.612.540
Strap coil, inside/outside Ø		200/430 mm

Further Technical Data

On page 3

Polypropylen straps and applications have to correspond with the strap specifications recommended by ORGAPACK!

Performance

Machines

- For strap width
- Arch dimension (width x height)
- Strap tension, up to
- Cycles per minute, up to
- Room temperature
- Relative humidity of air

OR-M 550 5 mm

650 x 500 mm
850 x 650 mm

300 N
70*
10–40°C
10–65%

OR-M 555 9/12 mm

650 x 500 mm
850 x 650 mm
850 x 850 mm

450 N
65*
10–40°C
10–65%

Performance:

Depends on arch and package dimensions, conveyor speed, package distances and strap tension

* Without conveying

Standard version

Options

CT Version (Cold and Tropic Environment) OR-M 550 / 555

Room temperature:

5–40°C

Relative humidity of air:
10–85%

- Rust-free feets and guide rolls
- Rust-free conveyor table
- Basic frame with special colour treatment



Conveyor height 950–1200 mm

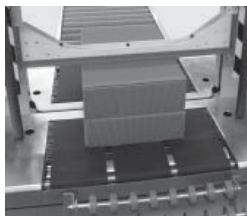

Hold down device

Pneumatic hold down device, pressing force up to 250 N, for containing lightweight packages during strapping cycle. Can be mounted at infeed and/or outfeed side of the machine. Compressed air consumption (6 bar): approx. 300 l/min.

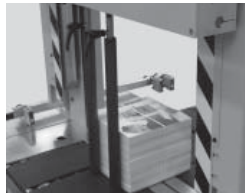

Bundle stops

Pneumatically driven front stops, for precise positioning of loose packages.

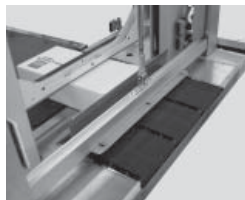

Package stops

Strap position adjustable from front edge of package: package infeed from 85–125 mm.

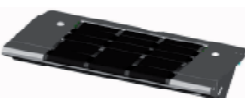

Conveyor extension

The belt conveyor system can be extended on the infeed and outfeed side, by 120 mm on each side.



Fixable feets

With adjusted feets the machine can be supported and fixed on the floor



Package height

If strapping height exceeds or remains under the adjusted value, strapping is prevented.

Second strapping tension

If the package height exceeds the adjusted photocell a stronger pre-adjusted tension will be applied.



Strapping in the centre

The packages are – independent of its length – automatically strapped in the centre.

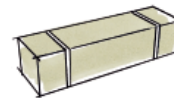

First strapping position

For parallel strapping. High operating convenience due to direct access to strapping position by shifting the photocells.

Potential free signals in 24 pin Interface plug

- Strap end
- Strap end pre-warning
- Automatic Mode
- Conveyor signal for infeed and down stream conveyor
- Cycle counter

Transport stop

When there are no packages on the infeed side of the machine, the conveyor stops automatically until a new package is on the conveyor.



Triple signal lamp: red, green, orange

Different machine status are optically displayed and every machine fault is indicated by the signal lamp.



Strap end pre-warning with signal lamp (white)

When the coil diameter falls below a pre-adjusted value, the white indicator lamp will be activated. This enables a coil to be prepared in advance to minimise production down time.

Layout

Arch dimension
650 x 500 mm

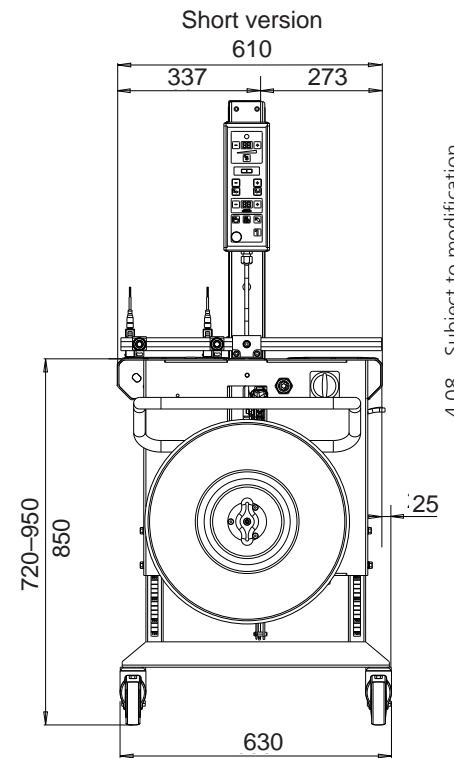
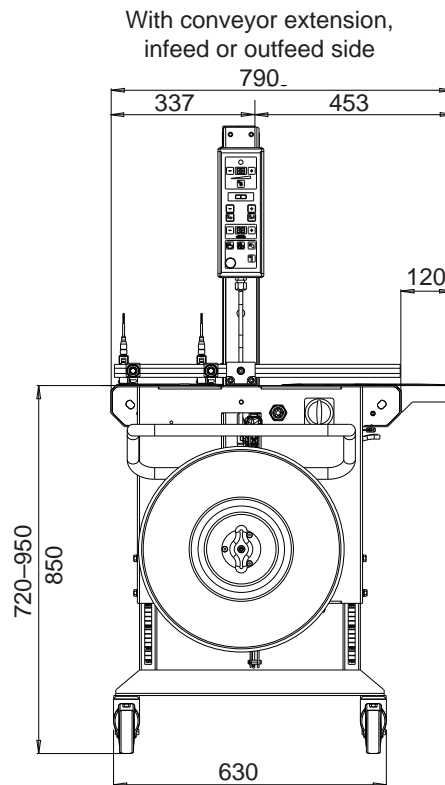
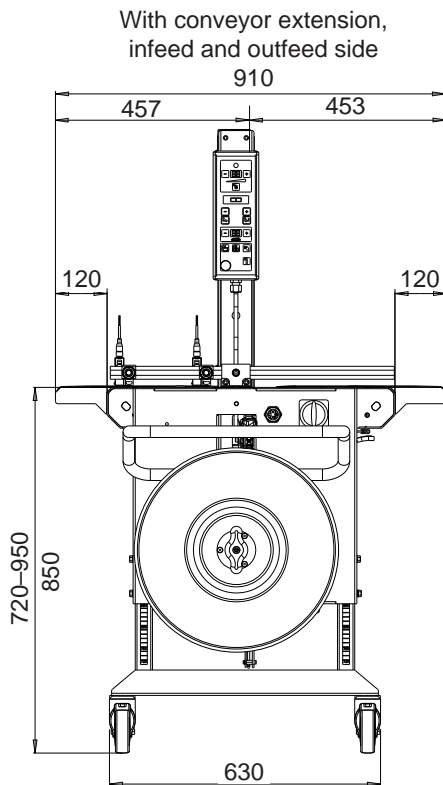
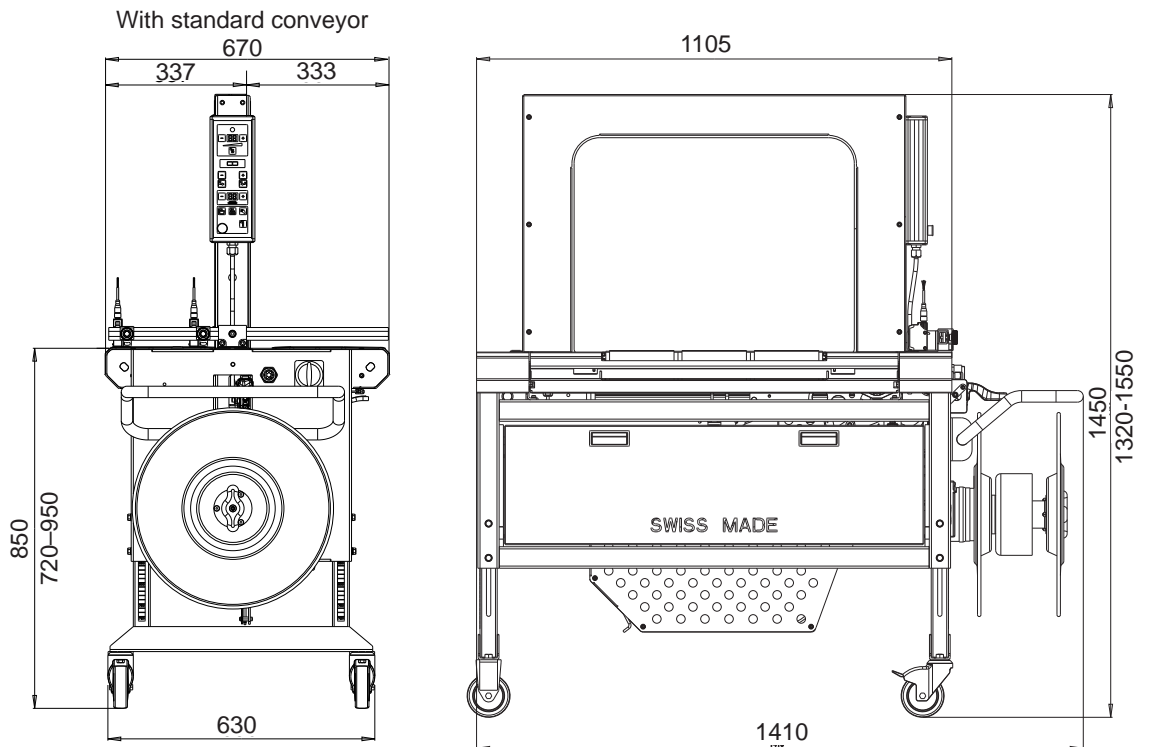

4.08 Subject to modification

ORGAPACK GmbH
Packaging Technology

Silbernstrasse 14
CH-8953 Dietikon
Phone +41 44 745 50 50
Fax +41 44 745 52 16
pt@orgapack.com
www.orgapack.com

Zertifikat ISO 9001 / EN 29001

OR-M 565

High performance side seal machine for plastic strapping

For large and heavy packages



Customer benefits

Characteristics	Customer benefits
Up to 65 cycles per minute	<ul style="list-style-type: none">• Fast strapping
Touch Panel	<ul style="list-style-type: none">• Strap tension easily adjustable• Flush operator controls
Simple technology, few moving parts	<ul style="list-style-type: none">• Reliable, also in continuous operation• Easily accessible (without tools)
Constant strap tension	<ul style="list-style-type: none">• For packages of different types and sizes
Ergonomically positioned dispenser	<ul style="list-style-type: none">• Simple and rapid coil change

Specifications

Standard equipment

- Adjustable working height
- Four castors with brakes
- Closed strap arch system
- Heat seal
- Automatic strap threading device
- Automatic strap end ejection
- Foot pedal (with option Interface not included)
- Touch panel with additional strap tension "Soft"
- Automatic strap loop ejection for cycles without product
- Cycle counter
- Electrical supply cable, 5 m
- Dispenser, above machine

Technical data

Max. cycles	65/min.
Arch dimensions (width x height)	300 x 600 mm*
	650 x 500 mm
	850 x 850 mm
	850 x 1250 mm
	850 x 1550 mm
Seal height	560–1040 mm
Electrical supply	230 V, 50 Hz
	115 V, 60 Hz

Strap tension

- with manual feed, up to 450 N
- with automatic feed (Option), up to 600 N

Room temperature	10–40°C
Relative humidity of air	10–65%
Emission sound pressure level	79 dB (A)
Weight	190 kg

Packages

Min. width x height	50 x 100 mm
Package weight, max.	50 kg

Plastic strap

Polypropylene (PP)	
9 mm	371.609.555
12 mm	371.612.540
Strap coil, inside/outside Ø	200/430 mm

* Model OR-M 5655



For integration into conveyor systems
or as a stand alone machine with non-driven rollers



For very large packages:
Arch dimension
850 x 1550 mm

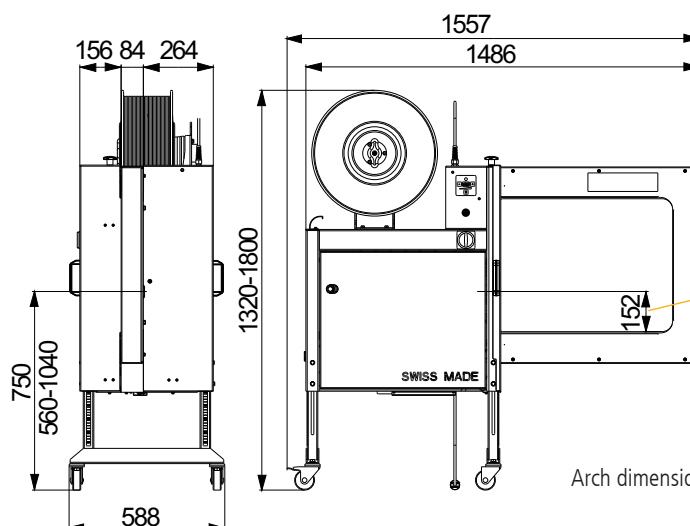

Arch dimensions (width x height) 650 x 500 mm

Highlights

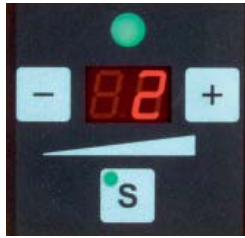

Exceptionally easy operation

Strap tension adjustable with press button



Robust, compact design



Strap for cost effective strapping

Use of thin PP strap



Simple coil change



Easily accessible

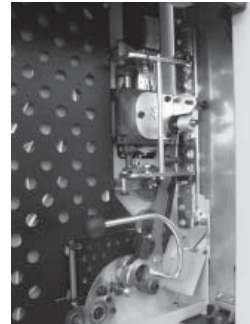

Easy fault clearance without tools



Minimum maintenance requirement without tools

Options



Adjustable feet

With adjustable feet the machine can be securely located



Roller table

- For max. working arch width of 650 mm
- Height adjustable
- Idle roller table
- Stainless steel roller



Standard interface

for integration into existing production lines for fully automatic (in-line) applications



Foot switch with protection cover



Support roller

Interface for high strap tension

for integration into existing production lines and strap tension up to

- 600 N for fully automatic applications
- 450 N for manual operation

Further options

- **Dispenser turned 90°**
Coil loading from rear side of machine
- **Special sealing height**
Other heights than 560–1040 mm

ORGAPACK GmbH
Packaging Technology

Silbernstrasse 14
CH-8953 Dietikon
Phone +41 44 745 50 50
Fax +41 44 745 52 16
pt@orgapack.com
www.orgapack.com

Certificate ISO 9001 / EN 29001